

INDIANA LURE COURSING CLUB



www.indianalurecoursingclub.org

ALL BREED AKC LURE COURSING FIELD TRIAL AND TEST

Saturday, April 7, 2018 (Event #2018684401) TRIAL and QC/JC
Sunday, April 8, 2018 (Event #2018684402) TRIAL and QC/JC

REGION SIX

Academy of Model Aeronautics (AMA)
5161 E Memorial Drive
Muncie, IN

EARLY ENTRIES close Wednesday, April 4, 2018 6:00pm
DAY OF TRIAL ENTRIES close at the FTS table at 8:00am

TRIAL HOURS: 7:00am through completion
\$15 early entry fee or \$20 at the gate for each test.
\$15 early entry fee or \$25 at the gate for each trial.

Roll call for Saturday and Sunday will be at **8:00am**. Dogs belonging to trial workers may be inspected early.

Permission has been granted by The American Kennel Club for the holding of this event under The American Kennel Club Rules and Regulations.

ILCC Officers:

President: Leslie Reeve; Vice-President: Jerry Burrus; Secretary: Jay Parks; Treasurer: Vada Cramer-Burrus.

Field Chairperson: Jay Parks, 556 N Highland Ave, Indianapolis, IN 46202; eclecticvibe@indy.com.

FTS: Karen Frost, 1826 W 400 N, Greenfield, IN 46140
808-384-1358; frostsalukis@aol.com

All entries must be mailed to FTS with checks payable to ILCC. Entries will not be taken by email or fax.

Lure Operators: Jerry Burrus, Kevin Carlson, Jeff Leonard, Don White, Joe Shoemaker, Dean Wright.

Judges and Assignments:

Kevin Carlson, P. O. Box 044421, Racine, WI 53404
Karen Rockwell, 3438 Helen Rd, Shaker Heights, OH 44122
Don White, 5599 Grove City Rd, Grove City, OH 43123
Dean Wright, 446 Baltimore St, Hanover, PA 17331

Running Order as posted Below.

Saturday: QC and JC to be judged by Dean Wright following Singles.

Sunday: QC and JC to precede IW and to be judged by Don White.

| SAT | IB | PH | AF | BO | BA | IW | IG | W | G | RR | SD | SA | RARE | SING |
|-------|----|----|----|----|----|----|----|---|---|----|----|----|------|------|
| KAREN | | | | | X | | X | X | X | | X | X | | |
| DEAN | | | X | X | X | | | X | | X | | | | |
| DON | X | X | | | | X | X | | X | X | X | X | | |
| KEVIN | X | X | X | X | | X | | | | | | | X | X |

| SUN | IW | PH | W | BO | SA | RR | SD | G | IB | BA | AF | IG | RARE | SING |
|-------|----|----|---|----|----|----|----|---|----|----|----|----|------|------|
| KAREN | X | X | X | X | | X | | | X | | X | | | |
| DEAN | X | X | | | X | | X | X | | | | X | | |
| DON | | | X | X | | | | | | X | X | | X | X |
| KEVIN | | | | | X | X | X | X | X | X | | X | | |

Stakes will run in order of Open, Specials, and Veterans.

Ribbons

QC/JC qualified: dark green

1st blue, 2nd red, 3rd yellow, 4th white, 5th pink, BOB purple and gold

Best in Field: Red, White and Blue

Late, incomplete, unsigned, unpaid, conditional entries or entries without registration number will not be accepted. Entries WILL NOT be acknowledged by phone or mail. **Please fill out an entry for each hound for EACH day.**

Fax or E-Mail entries WILL NOT be accepted. Substitutes for lame or in-season hounds are allowed if the substitute has the same owner and the FTS is notified by 7:30am the day of the trial.

ANY RETURNED CHECK WILL BE ASSESSED A RETURNED CHECK CHARGE of \$40.00.

Eligibility: Only Afghan Hounds, Azawakhs, Basenjis, Borzoi, Cirneco dell'Etna, Greyhounds, Ibizan Hounds, Italian Greyhounds, Irish Wolfhounds, Norrbottenspet, Peruvian Inca Orchids, Pharaoh Hounds, Portuguese Podengo Medio/Grande, Portuguese Podenjo Pequeno, Rhodesian Ridgebacks, Salukis, Sloughis, Scottish Deerhounds, Thai Ridgebacks, and Whippets that are at least one year of age. The hound must be individually registered with the American Kennel Club or an AKC recognized foreign registry or have an ILP or PAL number from the AKC. Norrbottenspet, Peruvian Inca Orchid, Portuguese Podengo Medio/Grande, Sloughi and Thai Ridgebacks recorded with AKC Foundation Stock Service (FSS).

Late, incomplete, unsigned or UNPAID entries will NOT be accepted. Entries will NOT be acknowledged by mail. Bitches in season, hounds with breed disqualifications and lame hounds will be excused and their entry fee refunded. Hounds not present at the time of roll call will be scratched. Owners may substitute for lame or in-season hounds but must do so before day of trial entries close. Please do not bring bitches in season to these trials, just report the bitch in-season to the trial secretary.

Conditions of Entry: Hounds under disqualification for AKC, ASFA or CKC field trials may not be entered in Open, Veteran or Specials Stakes.

AKC Tests:

QC/JC Tests: A hound at least 12 months of age. The course is a minimum of 600 yards with a minimum of four turns.

TRIAL STAKES OFFERED:

SINGLES: Any eligible sighthound including those disqualified to run in other stakes may participate to run.

OPEN: Open only to hounds of eligible breeds (with no breed disqualifications) that have attained one of the following: AKC QC, Field championship title from ASFA or the CKC. Championship points earned from the Open Stake will only count toward a FC title. Hounds that have earned an AKC FC title are not eligible to enter the Open Stake.

SPECIALS: Open only to all hounds that have earned their AKC FC title. Championship points earned from the Specials Stake will count towards LCX titles.

VETERAN: Open to all hounds which are eligible to enter either Open or Special Stakes, and meet the age requirement for a veteran as established by the breeds' parent club. Championship points will be awarded. Points from the Veteran Stake may count toward either a FC title or LCX title.

BEST IN FIELD (BIF): Will be offered both days. Note: Italian Greyhounds and Foundation Stock Service (FSS) breeds are not eligible to compete for Best in Field.

Emergency Vet:

Northwood Vet Emergency Practice
3255 North State Rd 9
Anderson IN
Phone: 765-649-5218

The lure will consist of highly visible plastic strips and will run on a battery-powered continuous loop system. Back-up equipment will be available.

A penalty of \$5.00 will be assessed for any hound that is loose on the field and not in competition with the course in progress.

There will be a \$5.00 fee assessed to anyone who fails to pick-up after their hound.

NO SMOKING or tobacco of any kind allowed on the trial grounds.
NO parking on the grass. Fine will be by AMA (Academy of Model Aeronautics).

Bring your own shade and water. Clean up after your dogs.

Any person, upon reasonable complaint, may be asked to leave the grounds of the field trial by the Field Committee and may be disciplined AKC.

Practice will be offered, equipment and time permitting. Cost will be \$3 per practice run.

COURSE PLANS:

The course plan will be reversed for finals, run-offs, Best of Breed and Best in Field. ILCC reserves the right to alter the course as required by weather and/or field conditions on the day of the trial.

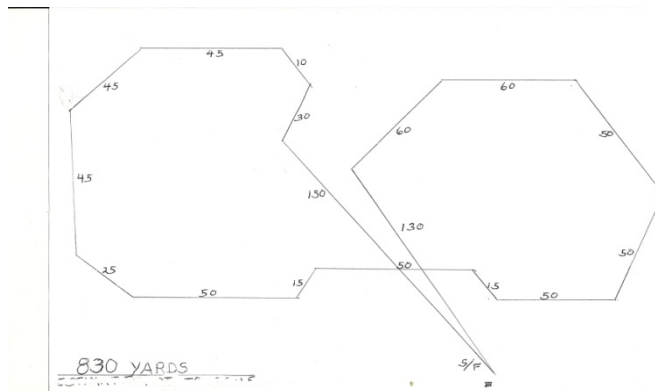

Saturday

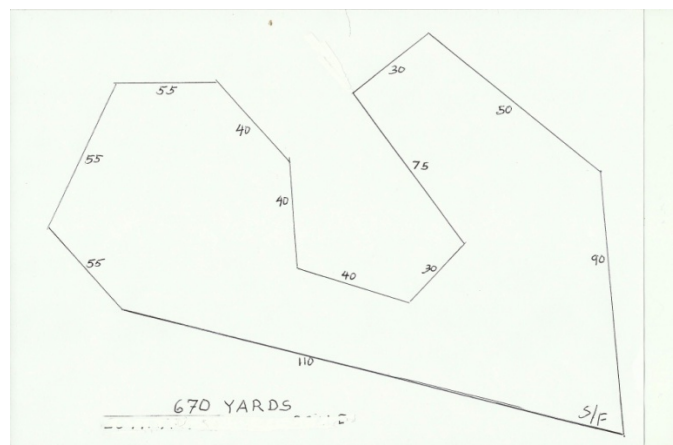

Sunday

LODGING: Following is a list of motels in the area. Please check directly with each one for dog restrictions.

MUNCIE AREA: Best Western – 765-282-0600

Super 8 – 765-286-4333

Lees Inn – 765-282-7557

Comfort Inn – 765-282-6666

Days Inn- 765-288-2311

ANDERSON AREA: Best Western – 765-649-0451

Motel 6 – 765-644-4422

Red Roof Inn – 765-640-1356

Americas Best Value Inn – 765-642-4384

Holiday Inn Holidome – 765-644-2581

Breakfast and Lunch will be available for purchase both days from Will-Yums Bar-B-Q Lunch Wagon. Good food at a reasonable price.

CAMPING and RV parking Allowed in designated areas only. Call the AMA at (800)-435-9262 Charges may differ, and are regulated by AMA.

- Primitive Camping—no electricity or water \$5 per night.
- RV/Motor home—no electricity or water \$5 per night.
- RV/Motor home—with electric hookup \$15 per night (total number of electric hookup sites 43)

All campers must register with AMA. Register during normal business hours (8 a.m.-5 p.m. Monday through Friday; Museum Store 10 a.m.-4 p.m. weekends, closed Sundays Thanksgiving through Easter) at the Administration Building or the Museum Store. Campers who use electricity and stay longer than 6 nights will receive a discount on their rental fees.

A RV dump station is available on site.

Due to Indiana State Board of Health requirements, all campers (primitive & RV) MUST register at one of the above mentioned locations. If someone arrives after hours, he/she should register first thing the next business day.

This will be monitored closely.

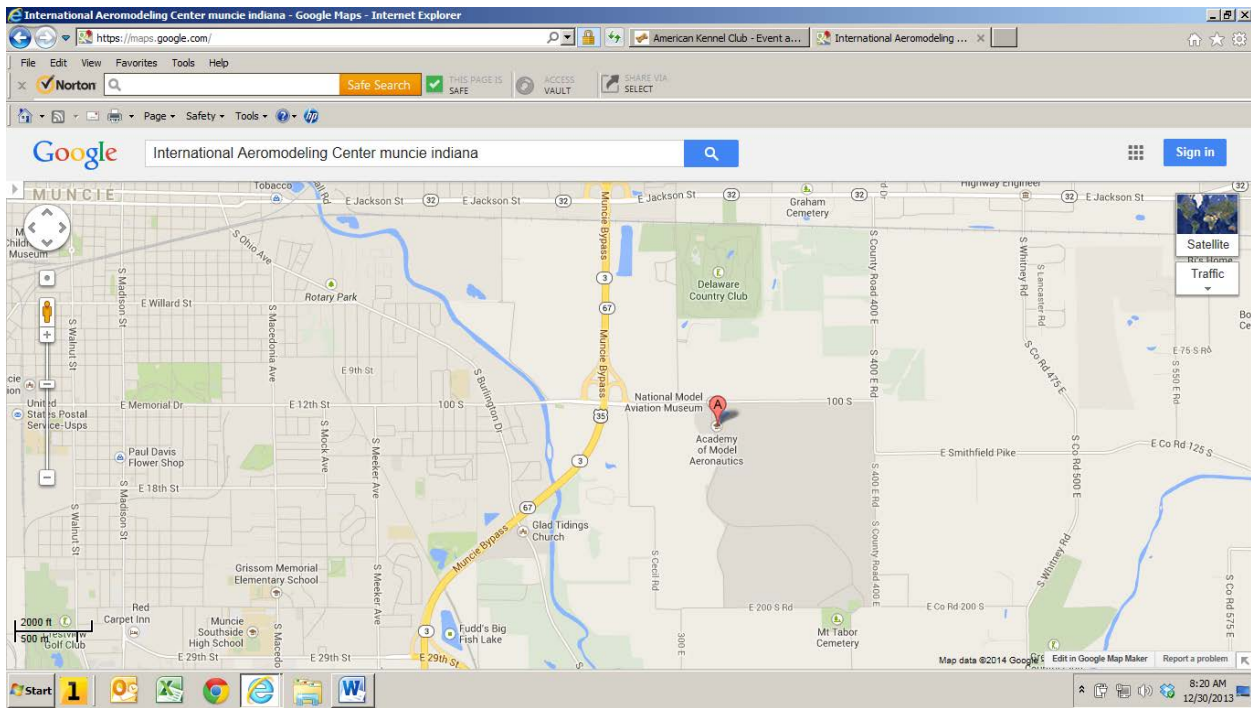

DIRECTIONS:

FROM THE EAST: Take Exit 149B which is Rt 35 North. Take Rt 35 north for approximately 33 miles to Rt 67. Take a right onto 67 and look for the Memorial Drive exit. Take the Memorial Drive exit and turn left at the end of the road. The AMA facility is on your right. Follow the ASFA signs to the field.

FROM THE NORTH (CHICAGO AREA): Take I-65 South to Route 28 East to I-69. Go south on I-69 to Exit 332 East. This will go through Muncie's business and mall area. Exit at Route 67 South and go to Memorial Drive. Exit at Memorial Drive and turn left at the end of the road. The AMA facility will be on your right. Follow the ASFA signs to the field.

FROM THE NORTH (FT WAYNE AREA): Traveling south on I-69 take Exit 332 East which goes through Muncie's business and mall area. Exit at Route 67 South and continue to the Memorial Drive. Exit at Memorial Drive and go left at the end of the road. The AMA facility will be on your right. Follow the ASFA signs to the field.

FROM INDIANAPOLIS AREA: From I-465 take the exit for I-69 North. Follow I-69 North to Rt 67 East (Exit 234). Go approximately 14 miles and take the exit for Memorial Drive. Turn left at the end of the road and the AMA facility is on your right. Follow the ASFA signs to the field.

OFFICIAL AMERICAN KENNEL CLUB LURE COURSING ENTRY FORM

| | | | | | |
|--|--|--|-----|---|--|
| Club: Indiana Lure Coursing Club | | Date: Saturday | | Event #: 2018684401 | |
| Location: Muncie, IN | | Event type (test or trial): Test ___ Trial ___ | | | |
| Stakes: JC ___ CAT ___ Singles ___ QC ___ Open ___ Special ___ Veteran ___ | | Breed: | | I enclose entry fees in the amount of: \$ | |
| Breeder: | | AKC No: | Sex | Date of Birth: | |
| Call Name: | | CP PAL/ILP No. Foreign & List Country | | | |
| Full Name of Dog: | | | | | |
| Sire: | | | | | |
| Dam: | | | | | |
| Actual Owner(s): | | | | | |
| Owner's Address: | | | | | |
| City: State: Zip | | | | | |
| Name of Owner's Agent/Handler (if any) at Trial: | | | | | |
| Please Separate My Entries. <input type="checkbox"/> | | | | | |
| AKC Rules, Regulations, Policies and Guidelines are available on the American Kennel Club website: www.akc.org AGREEMENT I certify | | | | | |
| <p>that I am the actual owner of the dog, or that I am the duly authorized agent of the actual owner whose name I have entered above. In consideration of the acceptance of this entry, I (we) agree to abide by the rules and regulations of The American Kennel Club in effect at the time of this event, and any additional rules and regulations appearing in the premium list of this event and entry form and any decision made in accord with them. I (we) agree that the club holding this event has the right to refuse this entry for cause which the club shall deem sufficient. In consideration of the acceptance of this entry and of the holding of this event and of the opportunity to have the dog judged and to win prizes, ribbons, or trophies, I (we) agree to hold the AKC, the event-giving club, their members, directors, governors, officers, agents, superintendents or event secretary and the owner and/or lessor of the premises and any provider of services that are necessary to hold this event and any employees or volunteers of the aforementioned parties, and any AKC approved judge, judging at this event, harmless from any claim for loss or injury which may be alleged to have been caused directly or indirectly to any person or thing by the act of this dog while in or about the event premises or grounds or near any entrance thereto, and I (we) personally assume all responsibility and liability for any such claim; and I (we) further agree to hold the aforementioned parties harmless from any claim for loss, injury or damage to this dog. Additionally, I (we) hereby assume the sole responsibility for and agree to indemnify, defend and save the aforementioned parties harmless from any and all loss and expense (including legal fees) by reason of the liability imposed by law upon any of the aforementioned parties for damage because of bodily injuries, including death at any time resulting therefrom, sustained by any person or persons, including myself (ourselves), or on account of damage to property, arising out of or in consequence of my (our) participation in this event, however such, injuries, death or property damage may be caused, and whether or not the same may have been caused or may be alleged to have been caused by the negligence of the aforementioned parties or any of their employees, agents, or any other persons. I (WE) AGREE THAT ANY CAUSE OF ACTION, CONTROVERSY OR CLAIM ARISING OUT OF OR RELATED TO THE ENTRY, EXHIBITION OR ATTENDANCE AT THE EVENT BETWEEN THE AKC AND THE EVENT-GIVING CLUB (UNLESS OTHERWISE STATED IN THIS PREMIUM LIST) AND MYSELF (OURSELVES) OR AS TO THE CONSTRUCTION, INTERPRETATION AND EFFECT OF THIS AGREEMENT SHALL BE SETTLED BY ARBITRATION PURSUANT TO THE APPLICABLE RULES OF THE AMERICAN ARBITRATION ASSOCIATION. HOWEVER, PRIOR TO ARBITRATION ALL APPLICABLE AKC BYLAWS, RULES, REGULATIONS AND PROCEDURES MUST FIRST BE FOLLOWED AS SET FORTH IN THE AKC CHARTER AND BYLAWS, RULES, REGULATIONS, PUBLISHED POLICIES AND GUIDELINES.</p> | | | | | |
| Signature of owner or agent duly authorized to make this entry: | | | | | |
| Tel: | | Email: | | | |



OFFICIAL AMERICAN KENNEL CLUB LURE COURSING ENTRY FORM

| | | | | | |
|--|--|--|-----|---|--|
| Club: Indiana Lure Coursing Club | | Date: Sunday | | Event #: 2018684402 | |
| Location: Muncie, IN | | Event type (test or trial): Test ___ Trial ___ | | | |
| Stakes: JC ___ CAT ___ Singles ___ QC ___ Open ___ Special ___ Veteran ___ | | Breed: | | I enclose entry fees in the amount of: \$ | |
| Breeder: | | AKC No: | Sex | Date of Birth: | |
| Call Name: | | CP PAL/ILP No. Foreign & List Country | | | |
| Full Name of Dog: | | | | | |
| Sire: | | | | | |
| Dam: | | | | | |
| Actual Owner(s): | | | | | |
| Owner's Address: | | | | | |
| City: State: Zip | | | | | |
| Name of Owner's Agent/Handler (if any) at Trial: | | | | | |
| Please Separate My Entries. <input type="checkbox"/> | | | | | |
| AKC Rules, Regulations, Policies and Guidelines are available on the American Kennel Club website: www.akc.org AGREEMENT I certify | | | | | |
| <p>that I am the actual owner of the dog, or that I am the duly authorized agent of the actual owner whose name I have entered above. In consideration of the acceptance of this entry, I (we) agree to abide by the rules and regulations of The American Kennel Club in effect at the time of this event, and any additional rules and regulations appearing in the premium list of this event and entry form and any decision made in accord with them. I (we) agree that the club holding this event has the right to refuse this entry for cause which the club shall deem sufficient. In consideration of the acceptance of this entry and of the holding of this event and of the opportunity to have the dog judged and to win prizes, ribbons, or trophies, I (we) agree to hold the AKC, the event-giving club, their members, directors, governors, officers, agents, superintendents or event secretary and the owner and/or lessor of the premises and any provider of services that are necessary to hold this event and any employees or volunteers of the aforementioned parties, and any AKC approved judge, judging at this event, harmless from any claim for loss or injury which may be alleged to have been caused directly or indirectly to any person or thing by the act of this dog while in or about the event premises or grounds or near any entrance thereto, and I (we) personally assume all responsibility and liability for any such claim; and I (we) further agree to hold the aforementioned parties harmless from any claim for loss, injury or damage to this dog. Additionally, I (we) hereby assume the sole responsibility for and agree to indemnify, defend and save the aforementioned parties harmless from any and all loss and expense (including legal fees) by reason of the liability imposed by law upon any of the aforementioned parties for damage because of bodily injuries, including death at any time resulting therefrom, sustained by any person or persons, including myself (ourselves), or on account of damage to property, arising out of or in consequence of my (our) participation in this event, however such, injuries, death or property damage may be caused, and whether or not the same may have been caused or may be alleged to have been caused by the negligence of the aforementioned parties or any of their employees, agents, or any other persons. I (WE) AGREE THAT ANY CAUSE OF ACTION, CONTROVERSY OR CLAIM ARISING OUT OF OR RELATED TO THE ENTRY, EXHIBITION OR ATTENDANCE AT THE EVENT BETWEEN THE AKC AND THE EVENT-GIVING CLUB (UNLESS OTHERWISE STATED IN THIS PREMIUM LIST) AND MYSELF (OURSELVES) OR AS TO THE CONSTRUCTION, INTERPRETATION AND EFFECT OF THIS AGREEMENT SHALL BE SETTLED BY ARBITRATION PURSUANT TO THE APPLICABLE RULES OF THE AMERICAN ARBITRATION ASSOCIATION. HOWEVER, PRIOR TO ARBITRATION ALL APPLICABLE AKC BYLAWS, RULES, REGULATIONS AND PROCEDURES MUST FIRST BE FOLLOWED AS SET FORTH IN THE AKC CHARTER AND BYLAWS, RULES, REGULATIONS, PUBLISHED POLICIES AND GUIDELINES.</p> | | | | | |
| Signature of owner or agent duly authorized to make this entry: | | | | | |
| Tel: | | Email: | | | |

